

ad notam® MarbleTV™ LINE

The **ad notam®** MarbleTV™ LINE
- applicatory Bathroom TV for Tile Environment Integration.

Seamlessly embedded into any wall architecture consisting of a tile pattern the **ad notam®** MarbleTV™ LINE is protected against humidity by a special casing and is therefore explicitly designed for operation in harsh environments (IP 67 ratings).

Whether you prefer morning shows, late night news or sport results, the stylish **ad notam®** MarbleTV™ LINE offers an all-in-one bathroom TV solution with a fully integrated TV, an invisible loudspeaker system and a water resistant remote control.

Due to the applicatory 3-Step Installation System the **ad notam®** MarbleTV™ LINE is ideal for construction projects:

As a first step the MarbleTV **assembly frame** gets recessed into the drywall. That simplifies the preparation of the cabling and visualizes the exact position in future stages of the project.

In a second step the **electronic plate** including all pre-assembled electronic components gets implanted into the frame with a simple slide-in mechanism.

In a third step the glass resp. mirror surface with the pre-mounted 17.3" LED-TFT Display completes the **decor finish**.



Article No.: TV Screen

Art.No.	GLASS TYPE	CODE	SIGNAL SYSTEM	CODE
MT_173	MAGIC MIRROR	_MM	PAL / SECAM	P
	Black Glass	_BL		
	White Glass	_WH	NTSC	N
	Crystal Mirror	_CR		
	Custom Colored Glass	_CG		

Article No.: Mounting Frame

Art.No.	TYPE	CODE
MT_173	MOUNTING FRAME FOR RECESSED INSTALLATION	_MF

Technical Datasheet:

Topview Marble TV

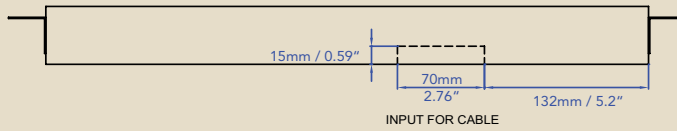

Frontview Marble TV

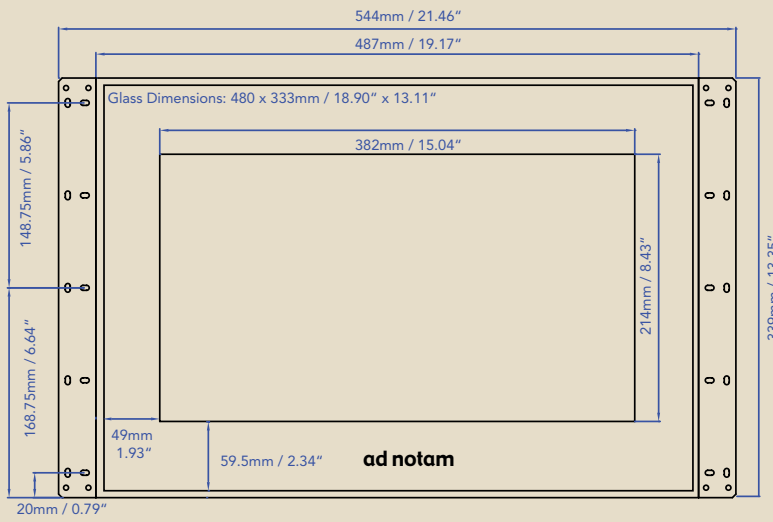

Backview Marble TV

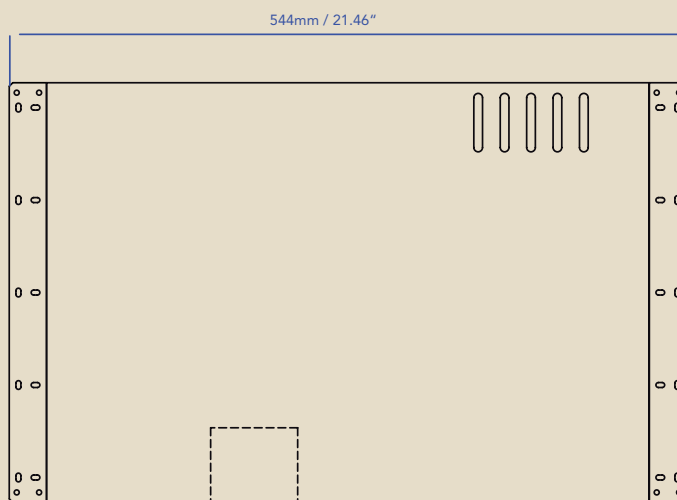

Sideview Marble TV



Screen Technology:

Art.No. / Features	MT_173_?? P	MT_173_?? N
Display Type	TFT Thin Film Transistor	TFT Thin Film Transistor
Active Screen Area	W x H 382 x 214 mm 15.04" x 8.43" Diagonal 438.3 mm / 17.3"	W x H 382 x 214 mm 15.04" x 8.43" Diagonal 438.3 mm / 17.3"
Picture Format	16:9	16:9
Physical Resolution	1600 x 900	1600 x 900
Viewing Angle	Horizontal 100 / Vertical 70	Horizontal 100 / Vertical 70
Brightness	220 cd/m ²	220 cd/m ²
Contrast	500 : 1	500 : 1
Response Time	8 ms	8 ms
TV-Inputs	DVB COFDM 2K/8K OPSK 16/64 QAM, PAL / SECAM, UHF / VHF	DVB COFDM 2K/8K OPSK 16/64 QAM, PAL / SECAM, UHF / VHF
Video-Inputs	HDMI (1080i/24,50,60 Hz), RGB (VGA, SVGA, XGA, SXVGA), SCART, Y/C, FBAS, RJ45	HDMI (1080i/24,50,60 Hz), RGB (VGA, SVGA, XGA, SXVGA), YRbPr, Y/C, FBAS, RJ45
Audio-Interfaces	HDMI 1.3, STEREO 3.5, RCA STEREO, DIGITAL AUDIO OUT, SPEAKER OUT	HDMI 1.3, STEREO 3.5, RCA STEREO, DIGITAL AUDIO OUT, SPEAKER OUT
Operating Temperature	5 to 50 Celsius / 41 to 122 Fahrenheit	5 to 50 Celsius / 41 to 122 Fahrenheit
Power	AC 100-240 V 19 W / 1600 mA	AC 100-240 V 19 W / 1600 mA
Weight	10.5 kg	10.5 kg
Amplifier Output	4 x Phoenix-clip, 3.5W RMS@4 Ohm per Channel	4 x Phoenix-clip, 3.5W RMS@4 Ohm per Channel
Filter	COMB FILTER / DEINTERLACE 3D	COMB FILTER / DEINTERLACE 3D
Tuner Receiver	PAL/SECAM, DVB-T MPEG2	PAL, DVB-T MPEG2
Tuner Channels	ATV: 100 / DTV: 400	ATV: 100 / DTV: 200
Sound System	BG, DK, I, L, L', NICAM/A2	BG, DK, I, NICAM/A2
FM Radio	no	no
Teletext / EPG / PIP	yes / yes / ---	yes / yes / ---
Interactive Port RJ45	IR / RS232 (optional)	IR / RS232 (optional)

ad notam® MarbleTV™ LINE

Power Supply:

Power	Voltage		Type	Operating Temperature
	IN	OUT		
35 W / 3A	90 – 264 VAC	12 V DC	Art. 10004179	0 - 40 °C

Topview
 Dimensions: 148mm / 5.83" (length), 40mm / 1.57" (width).
 Hole diameters: $\phi 3.6$.
 Spacing between holes: 3.5mm.

Sideview
 Height: 30mm / 1.18"



Integrated Loudspeaker:

Units in delivery scope	2
Sound Pressure Level	85 +/- 5dB at 1W/1m, at 1000Hz
Impedance	8 Ohms
Frequency Range	300-1500Hz (Related to surface being driven)
Power Handling	3 W (R.M.S)

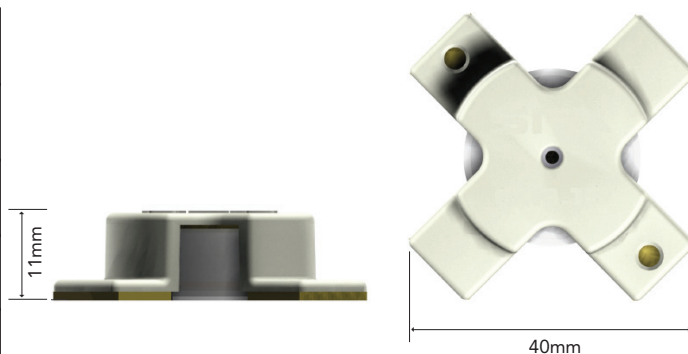

Remote Control (Infrared):

Type	Feature	Dimensions B x H x D
ET 515	waterproof universal & learning	150 x 60 x 11mm 5.91" x 2.36" x 0.43"

